

Model 4288 Adapter, SMA Male To BNC Male

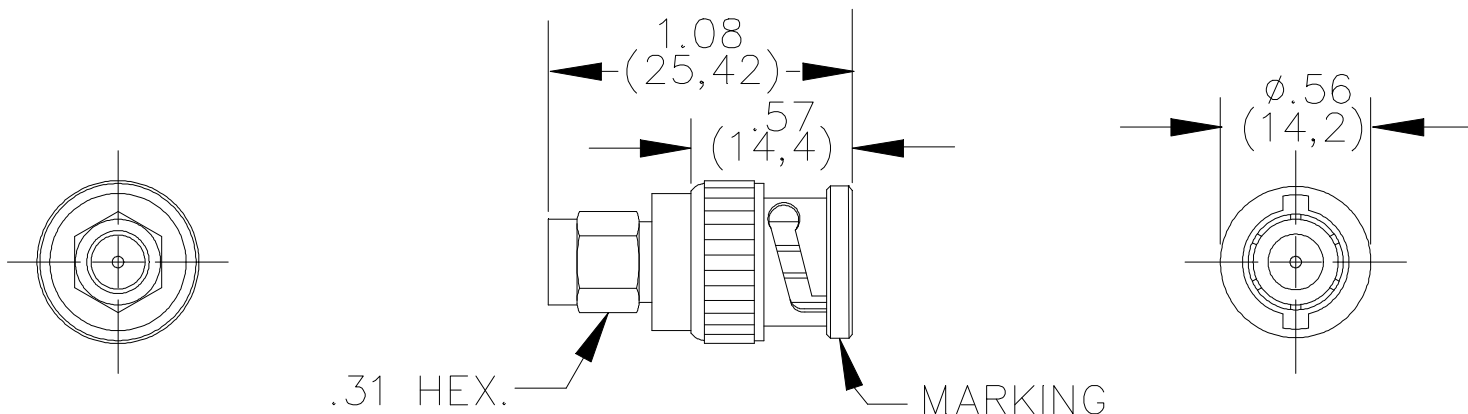

MATERIALS:

Body – Gold Plated Beryllium Copper, Male Contact - Gold Plated Brass,
 Dielectric: Teflon per L-P-403
 Finish: Body and Contacts – Gold plated per MIL-G-45204, Type II, Class 2
 Marking: “Pomona 4288”

RATINGS:

Voltage: Shield/Earth: 30VAC/60VDC Max.
 Inner Conductor/Shield: 335VRMS Max.
 Operating Temperature: -65°C (-85°F) to +165°C (+329°F)
 Nominal Impedance: 50 Ohms
 Frequency Range: 0-12.4 GHz.

ORDERING INFORMATION: Model 4288

All dimensions are in inches. Tolerances (except noted): .xx = ±.02” (.51 mm), .xxx = ± .005” (.127 mm).
 All specifications are to the latest revisions. Specifications are subject to change without notice.
 Registered trademarks are the property of their respective companies. Made in USA